



GIMA

PROFESSIONAL MEDICAL PRODUCTS

ENGLISH

All serious accidents concerning the medical device supplied by us must be reported to the manufacturer and competent authority of the member state where your registered office is located.

Thank you! Have you bought an aid intended for use in toilets or bathrooms. Its purpose is to facilitate the users to use the disabled toilets. Any

other use is prohibited. Use only in a seated position and do not stand on it; for mounting please refer to the explanatory images below. DO NOT install this product without first reading and understanding this instruction manual. Failure to consult the instructions may cause serious injury.

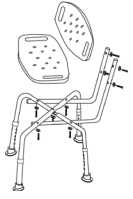

REF FS798L (27730)

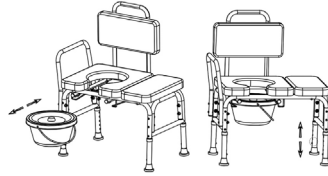

REF FS7992LU (27758)



REF FS894L (27759)

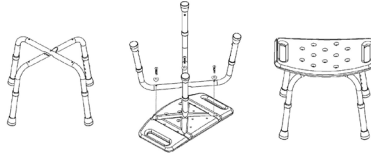

REF FS797L (42900) / FS7972L (42903) (ROUND SEAT)

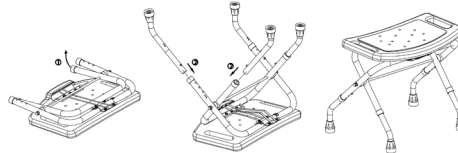

REF FS7963L (42901)

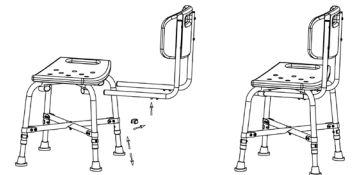

REF FS794L-1 (42910)

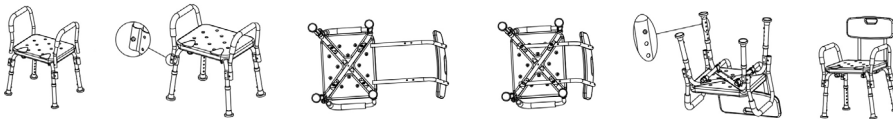

REF FS7985L (42907)

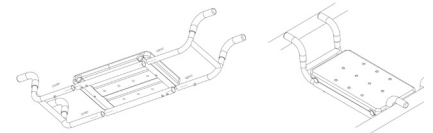

REF FS-794L-1 (42910)



REF FS7962L (42915)

Cleaning

Use damp cloth with normal detergents. Do not submerge the seat in the bath water; drain after use and dry the seat. Don't use harsh abrasives or bleach based cleaners.

Warning

- These products are recommended for people weighting 100 kg. maximum, for the code 42906 150 kg. maximum.
- The manufacturer and distributor decline all responsibility for any consequences resulting from an incorrect use of this product.
- Check that the product is in perfect condition before you use it.
- Do not store the products outdoors. Please check the stability of the product, if screws are properly tightened and the rubber tips are in good conditions before use.
- Please help people with movement difficulties to seat on the products.
- Avoid any hard movement during patient positioning on the chair. Pay attention on wet floors, can cause problems during patient positioning on the chair; do not stand on or use if there is on soap or mousse.
- Avoid sudden movements during positioning. Be careful wet floors, wet or slippery in general, could make it difficult patient positioning.
- The manufacturer will not be in any way responsible for improper or imprudent use of the product.
- Prior to each use check that all joints and fittings bench are tight.
- DO NOT place the product on uneven surfaces.
- DO NOT use if wobbly, unstable or not level.
- DO NOT twist or turn while seated on the device, this may cause frame to bend.
- Verify that the test leads are in good condition. If necessary, replace them immediately if worn or missing.
- Add the lubricating oil to the transmission parts regularly.

Working Condition

Temperature: 5 ÷ 38°C
Humidity percentage: 20 ÷ 90% RH
Atmospheric pressure: 800 ÷ 1060 hPa

Conservation condition and Transport

Temperature: - 10 ÷ 50°C
Humidity percentage: 20 ÷ 90%
Atmospheric pressure: 800 ÷ 1060 hPa

	Keep in a cool, dry place	REF	Product code
	Keep away from sunlight	LOT	Lot number
	Consult instructions for use	MD	Medical Device
	Medical Device compliant with Regulation (EU) 2017/745		Manufacturer
	Caution: read instructions (warnings) carefully		Date of manufacture
	Authorized representative in the European community		

GIMA WARRANTY TERMS

The Gima 12-month standard B2B warranty applies.



FS798L (27730) - FS7992LU (27758) - FS894L (27759) - FS797L (42900) - FS7963L (42901) - FS7972L (42903) - FS7981L (42906) - FS7985L (42907) - FS794L-1 (42910) - FS7962L (42915)



Foshan Dongfang Medical Equipment Manufactory (LTD.)
5 Xingfu Road, Zone A, Shishan Industrial Park,
Nanhai District, Foshan City, China, 528000
Made in China

Importato da / Imported by:
Gima S.p.A.
Via Marconi, 1 - 20060 Gessate (MI) Italy
gima@gimaitaly.com
export@gimaitaly.com
www.gimaitaly.com



MedNet EC-Rep GmbH
Borkstrasse 10. 48163 Muenster. Germany

